

1

2

3

4

A

A

B

B

C

C

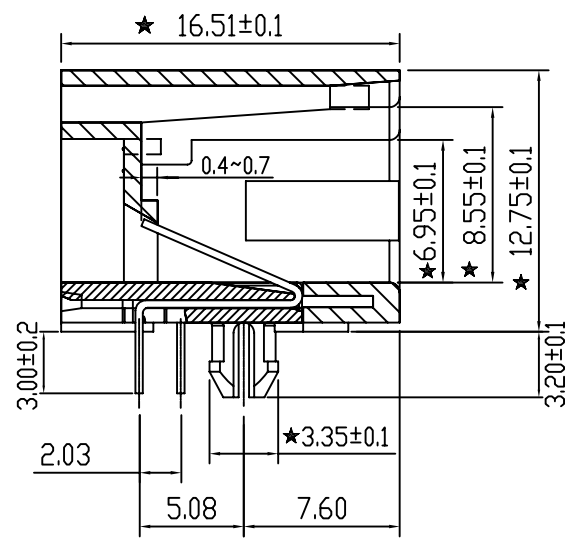
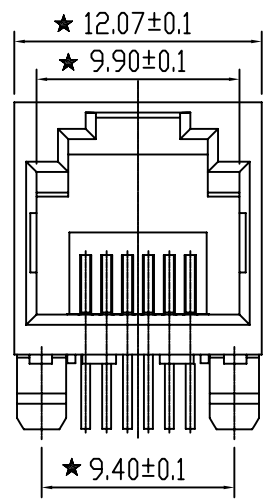

**SPECIFICATION NOTES:**

**ELECTRICAL:**

- VOLTAGE RATING: 125 VAC RMS
- CURRENT RATING: 1.5 AMP
- CONTACT RESISTANCE: 20mΩ MAX.
- INSULATION RESISTANCE: 1000MΩ MIN. AT 500V DC.
- DIELECTRIC STRENGTH: 1000 V AC OR 1500V DC RMS AT 0.5mA 50 Hz / 60 Hz FOR 1 MINUTE

**MECHANICAL:**

- HOUSING&INSERT&MATERIAL:SEE TABLE
- CONTACT MATERIAL:PHOSPHOR BRONZE T=0.35MM
- PLATING:GOLD PLATING AT CONTACT AREA, MATTE TIN AT TAIL 100U MIN., NICKEL 30U MIN. OVER ALL.
- OPERATING LIFE:750 CYCLES MIN.
- MATING/UNMATING FORCE: 30N/3.06KG MAX.
- RETENTION STRENGTH:50N MIN. FOR 60S±5S

**ENVIRONMENTAL:**

- STORAGE:-40° C TO +85° C RELATIVE HUMIDITY<80%
- GUARANTEE PERIOD:12 MONTHS
- OPERATION: -40° C TO +85° C
- WAVE SOLDERING TEMPERATURE: 260±5° C 5~10 SECONDS. MATES WITH MODULAR PLUG CONFORMING TO FCC PART 68, SUBPART F.

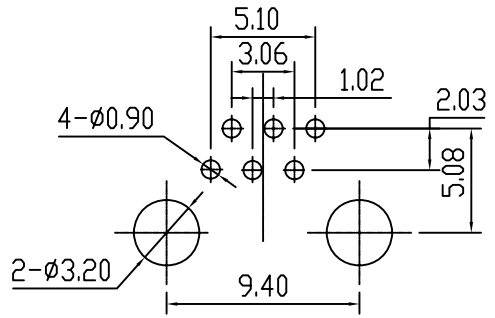
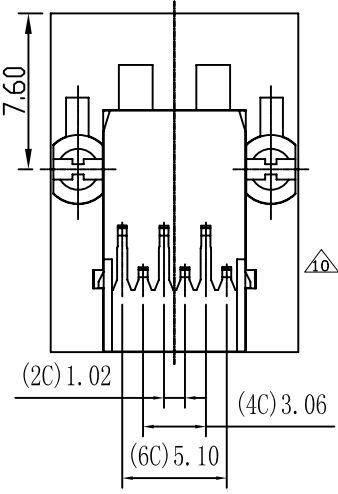

PCB LAYOUT  
TOLERANCES: ±0.05

**电气特性**

- 额定电压: 125 VAC RMS
- 额定电流: 1.5 AMP
- 接触电阻: 20 mΩ MAX
- 绝缘电阻: 1000 MΩ MIN. @500 VDC
- 耐压强度: 1000 V AC 或 1500V DC RMS @ 0.5mA 50 Hz 或 60 Hz 一分钟

**机构特性:**

- 塑壳材质: 见表格
- 扁针材质: 磷青铜, 厚度0.35MM
- 扁针电镀: 接触区镀金, 金厚度如表说明 全区镀镍底30U MIN., 剥头电镀雾锡100U MIN.
- 可靠性: 最少750次插拔;
- 插入/拔出力: 30N/3.06KG MAX.
- 配合强度: 50N 60S±5S.

**环境特性:**

- 储存温度: -40℃~+85℃ 相对湿度<80%
- 储存时间: 12个月
- 工作温度: -40℃~+85℃
- 波峰焊温度: 260±5℃ 5~10S

带★尺寸为重点管控尺寸  
塑壳图号: YZ2J0083 / 插芯塑壳图号: YZ2J0084

RoHS Compliant

**Coorle 库乐科技**

TOLERANCES

MATERIAL:

Designed:

唐望森 14.08.27

NAME:

5521-A单胞 6P系列 (扁针插芯式)

FINISH:

Checked:

DWG NO:

REV.

Approved:

PART NO:

SEE TABLE

10



A4  
SIZE

SCALE  
1:1

UNIT  
mm

CUSTOMER:  
MODEL NO:

N/A  
N/A

1

2

3

4